

TECEprofil – WC 980 mm

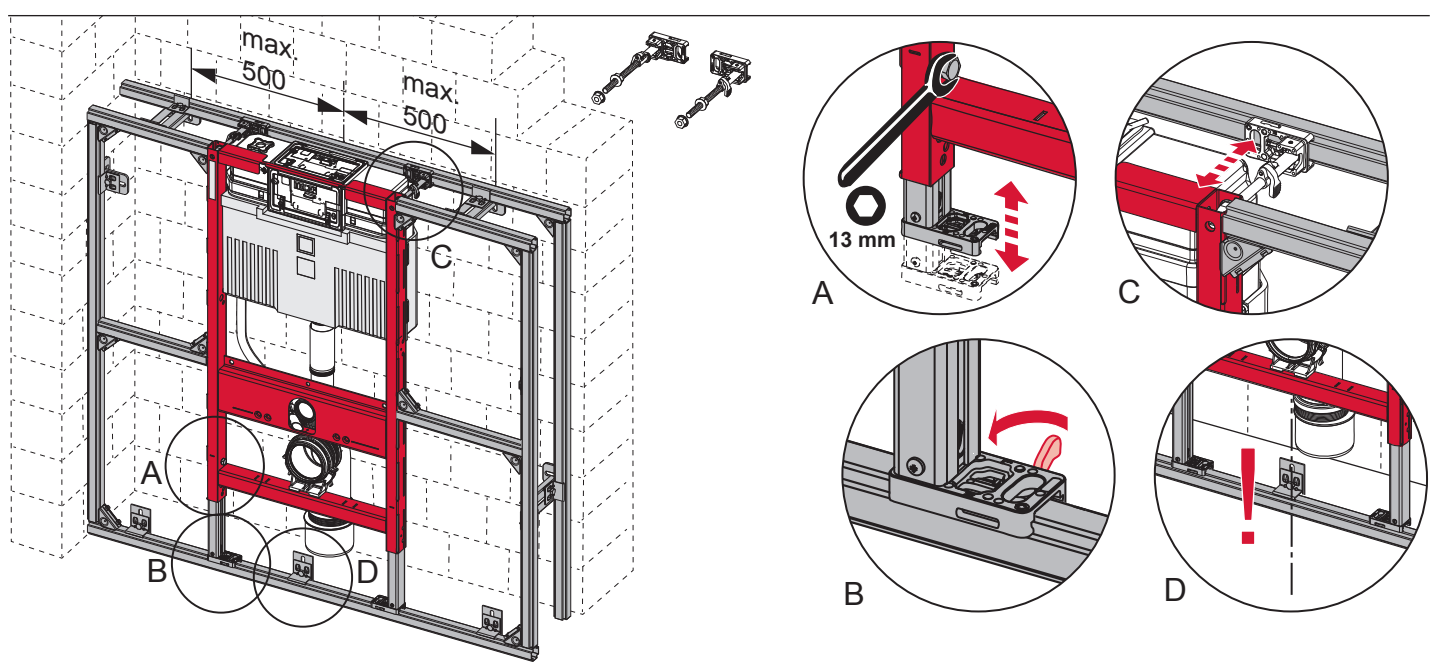

TECEprofil – WC 980 mm

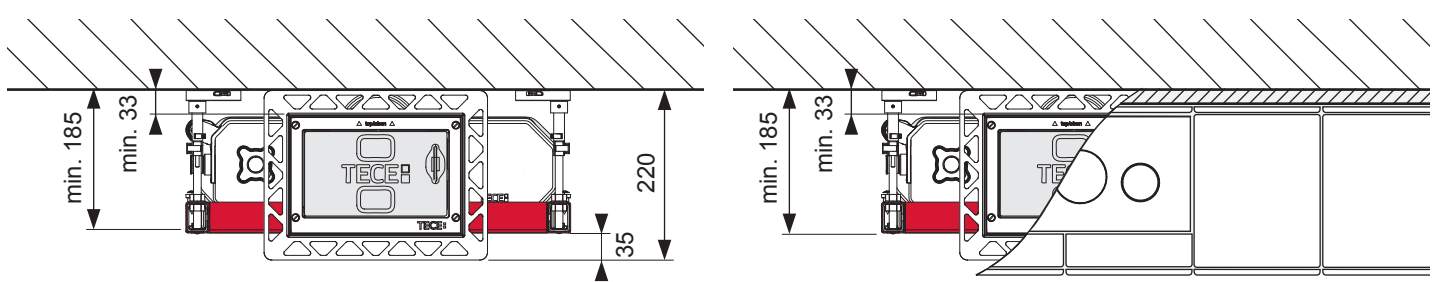
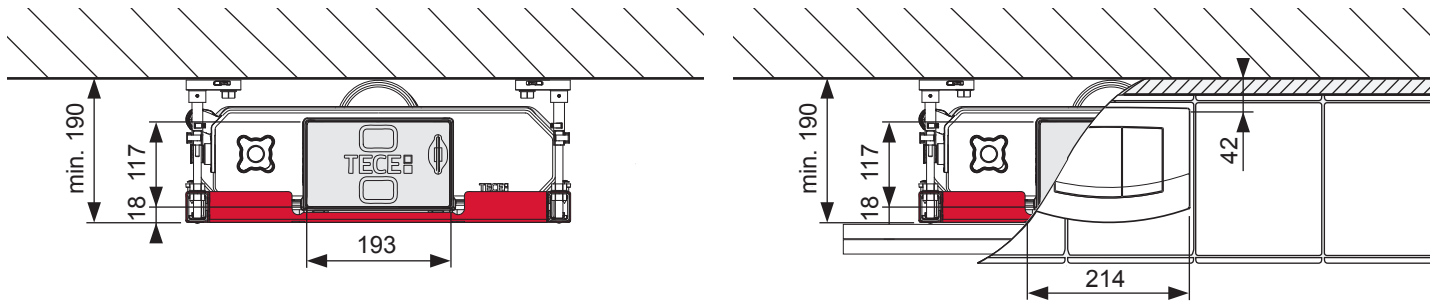
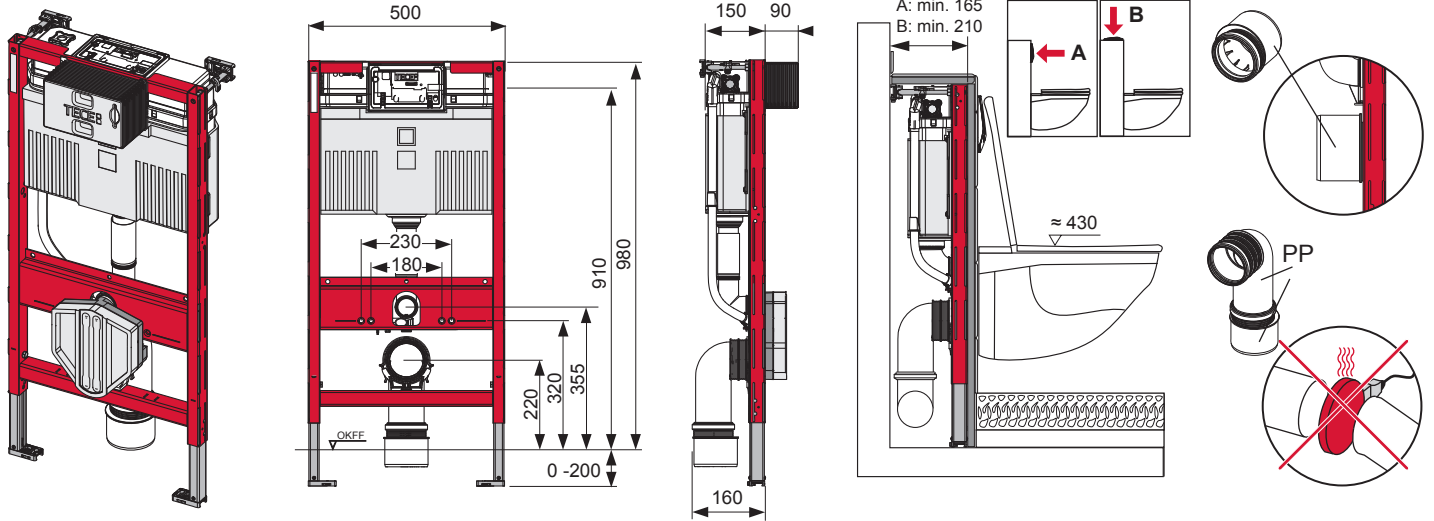
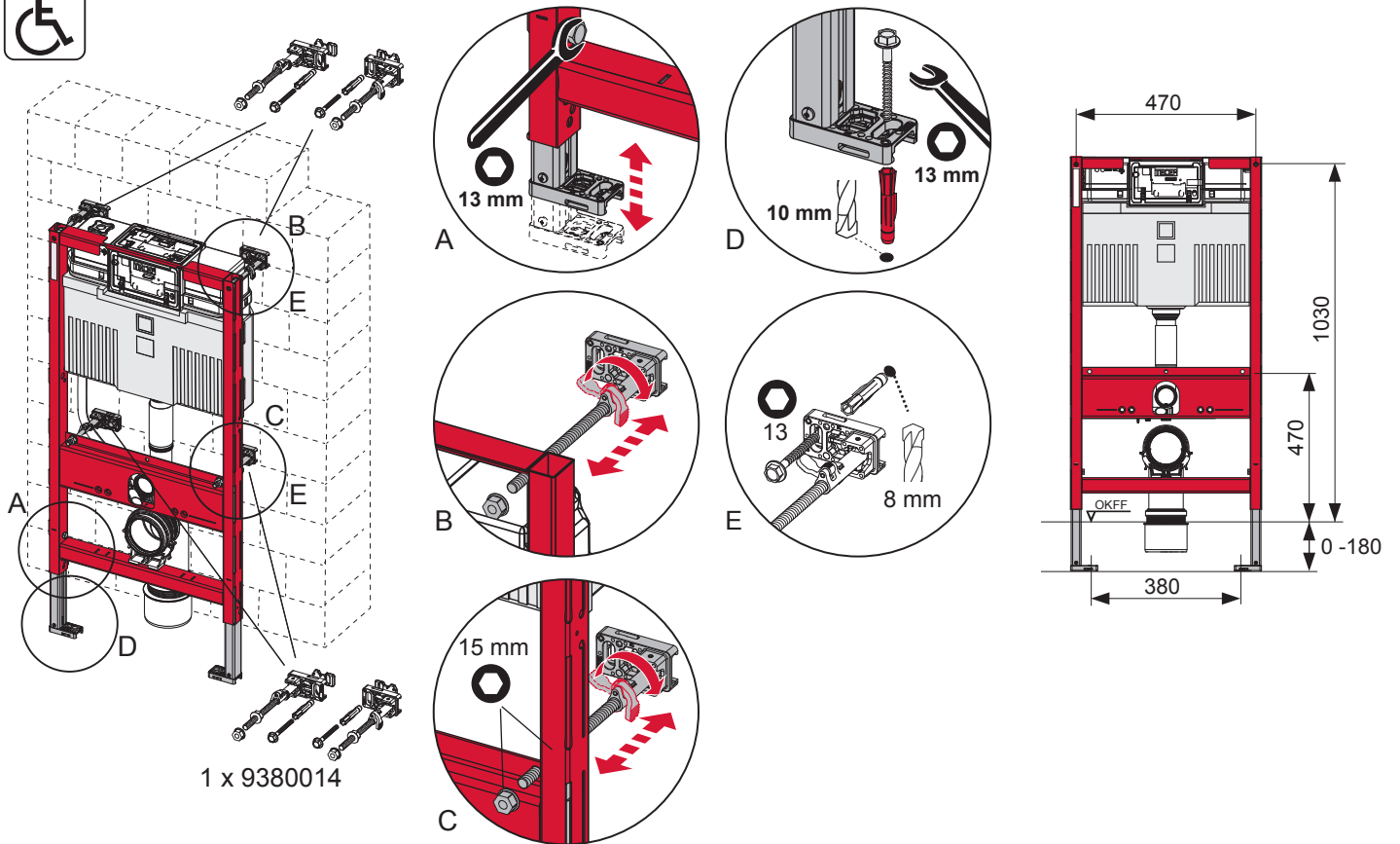
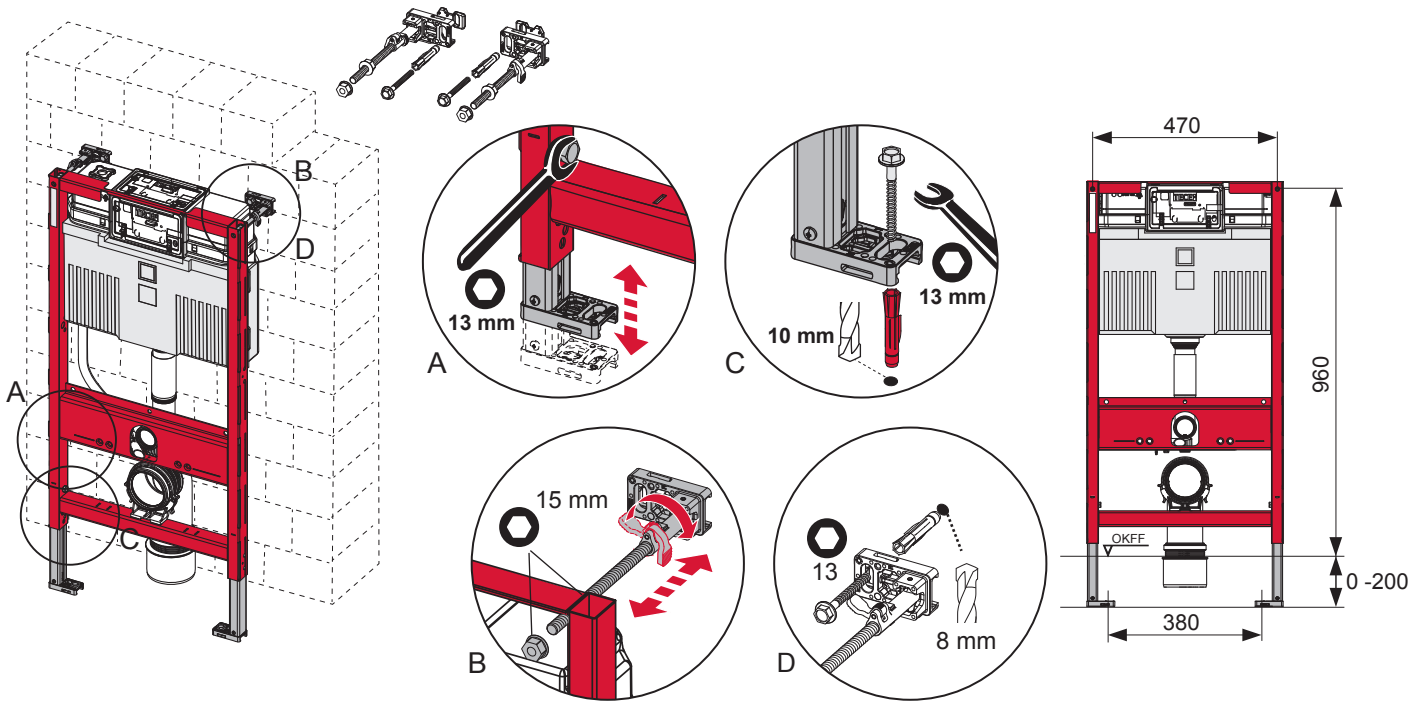

TECEprofil – WC 980 mm

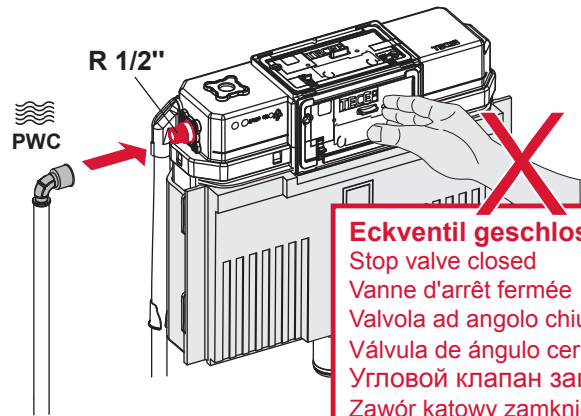
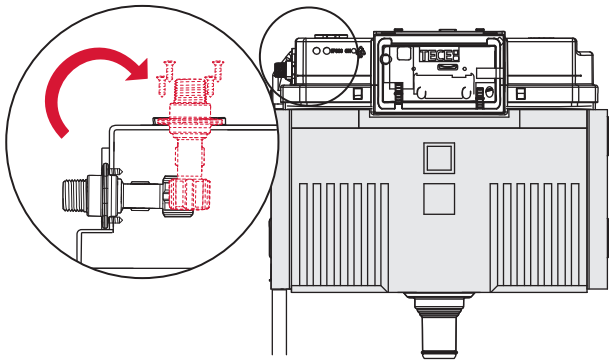

Eckventil geschlossen
 Stop valve closed
 Vanne d'arrêt fermée
 Valvola ad angolo chiusa
 Válvula de ángulo cerrada
 Угловой клапан закрыт
 Zawór kątowy zamknięty

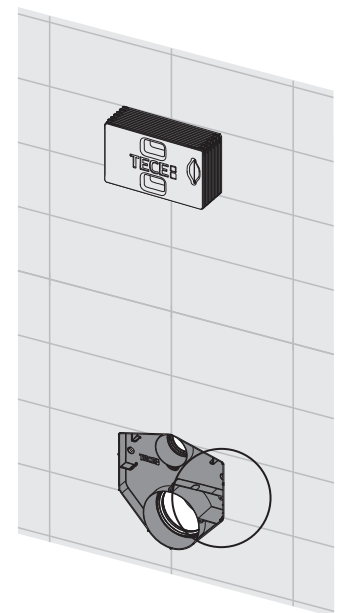
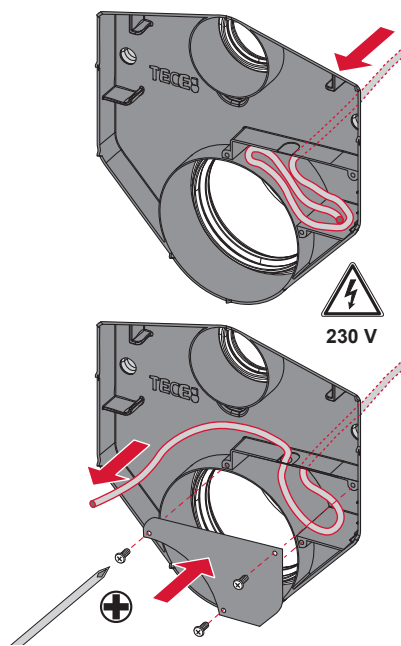
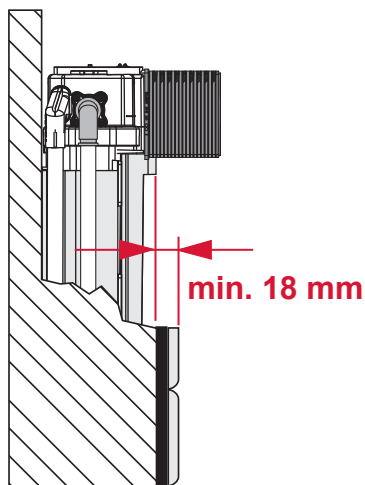
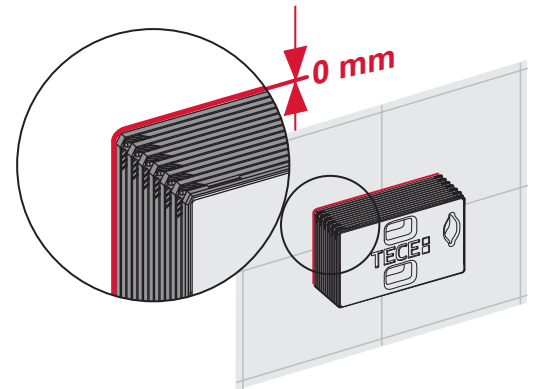
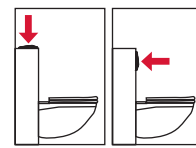
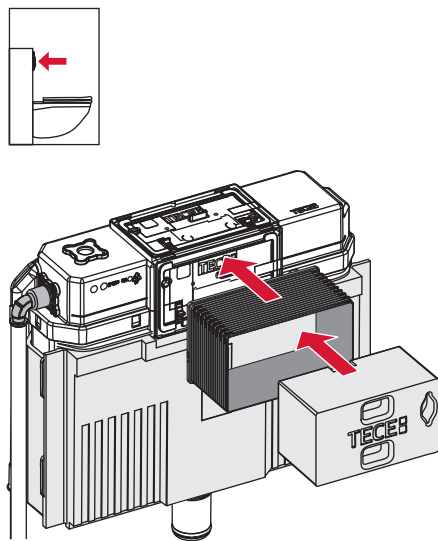
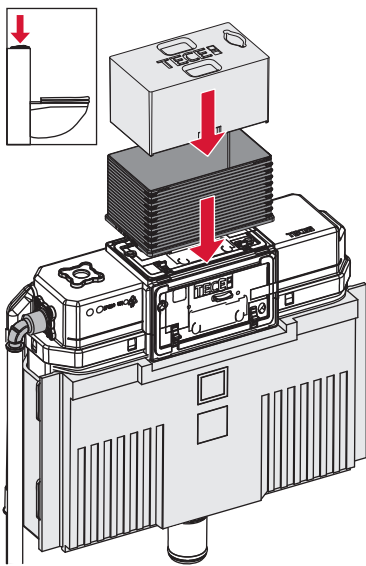

PR230 342 00 a

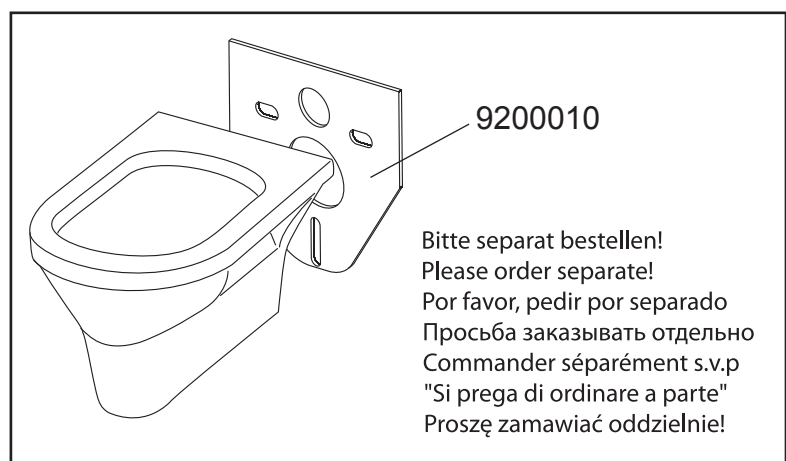
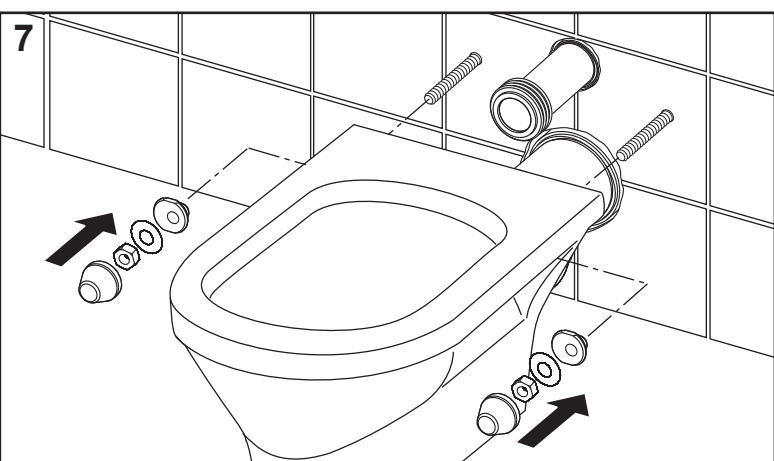
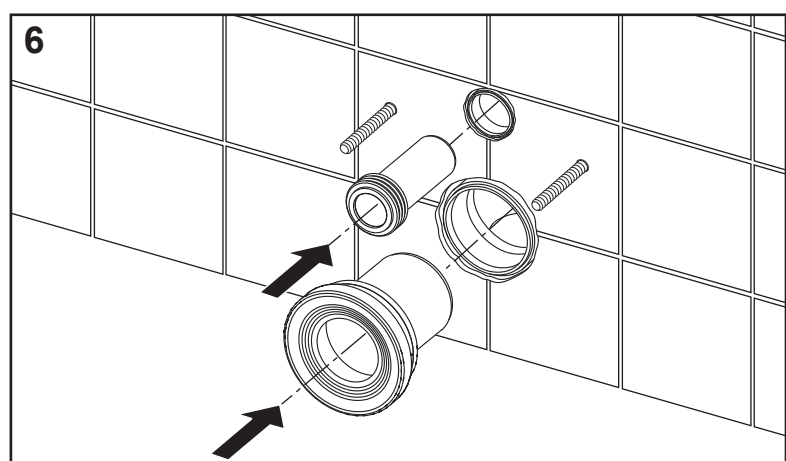
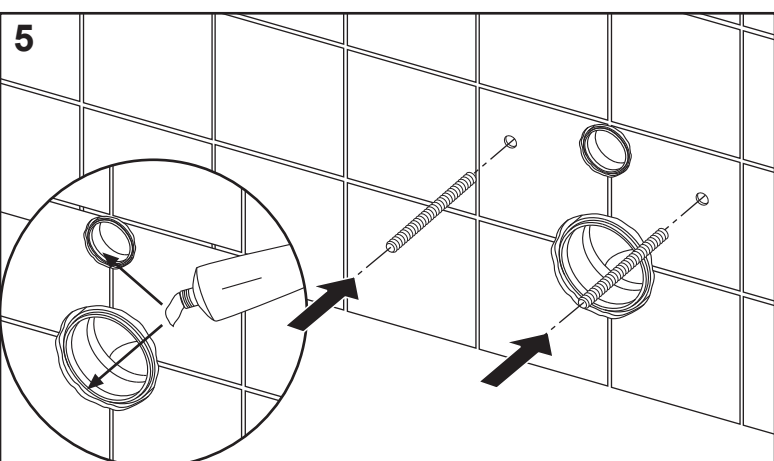
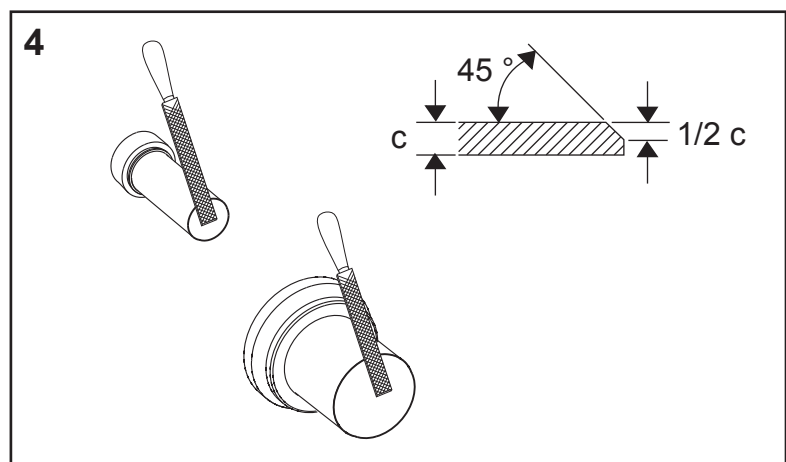
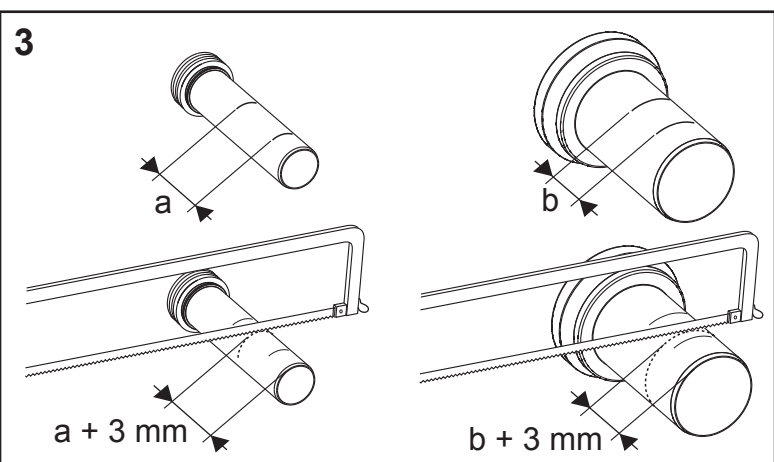
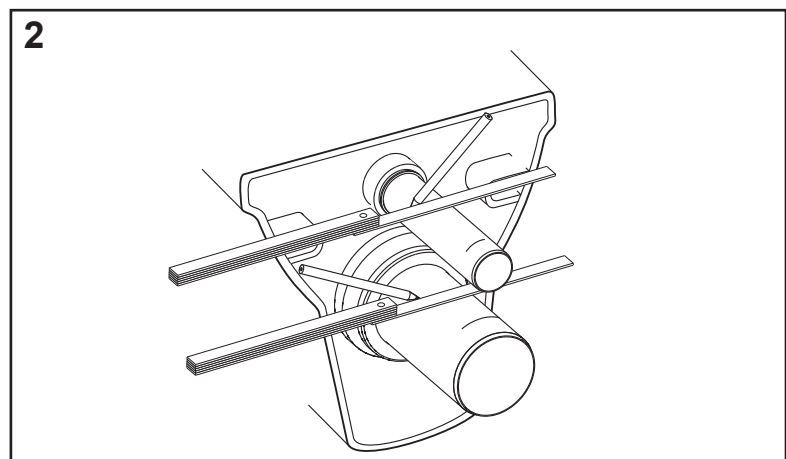
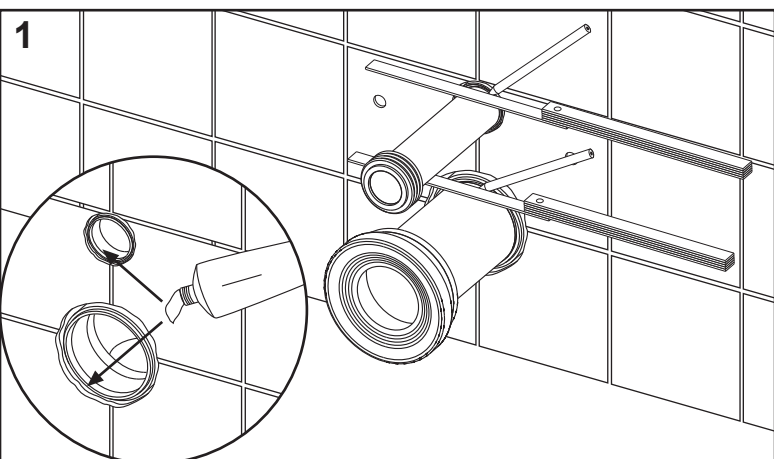

TECEprofil - Systemmontageanleitung / system assembling instructions

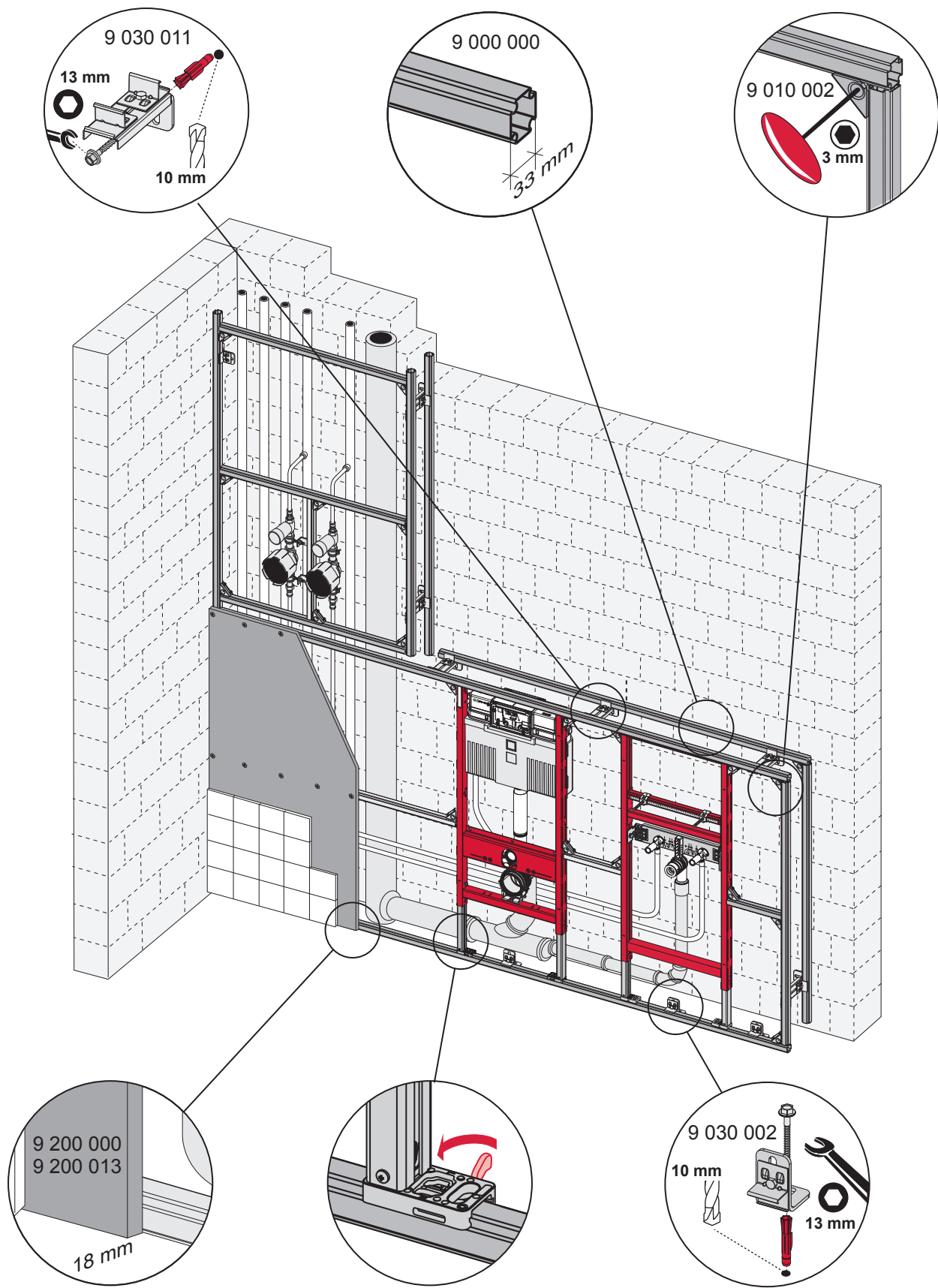

TECEprofil - Systemmontageanleitung / system assembling instructions

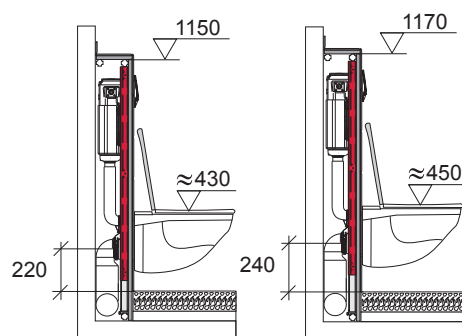
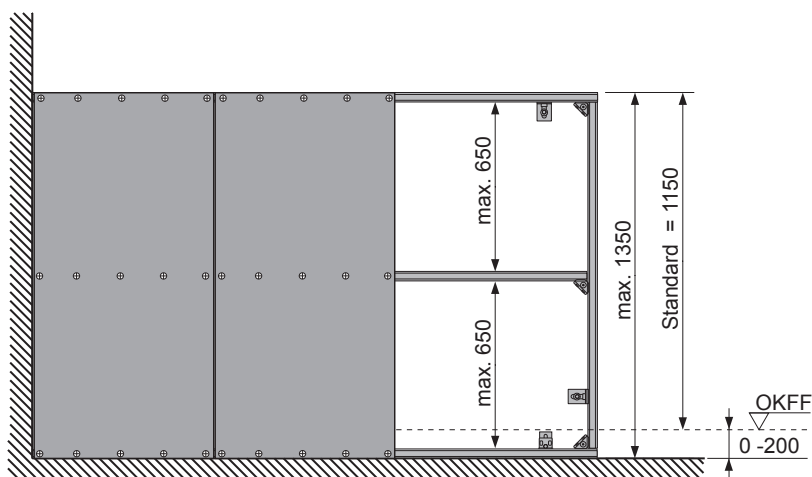
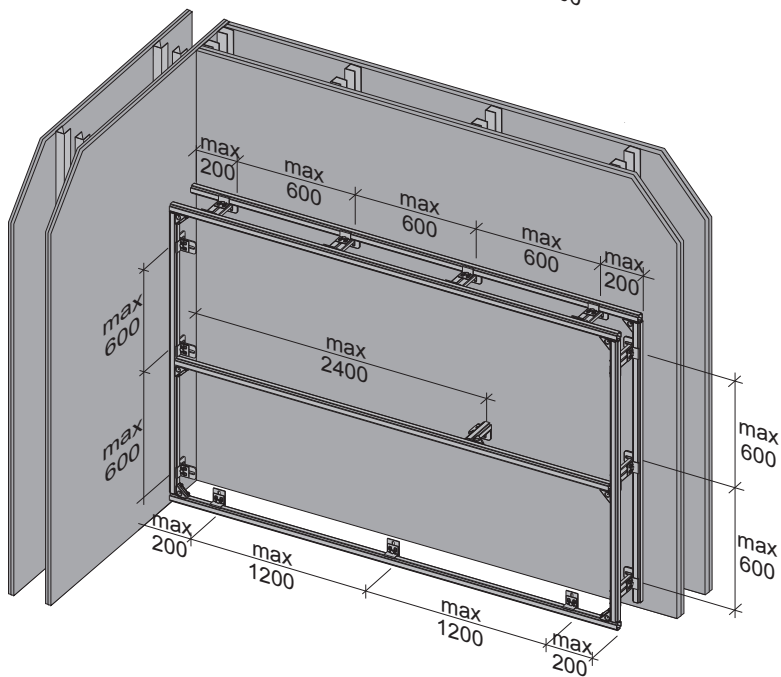
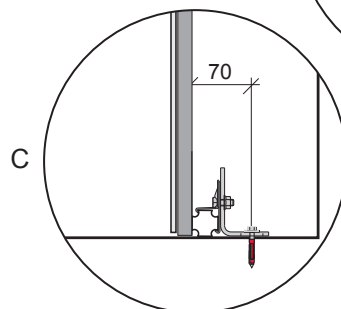
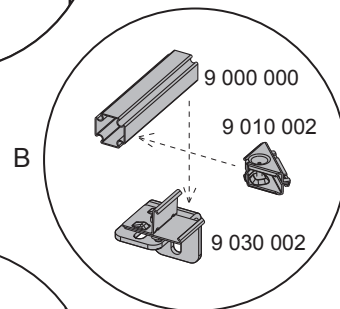
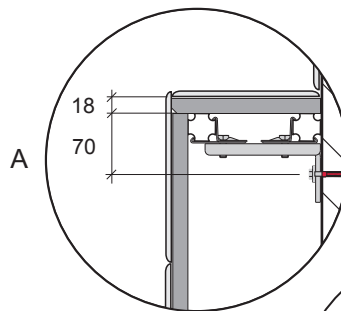
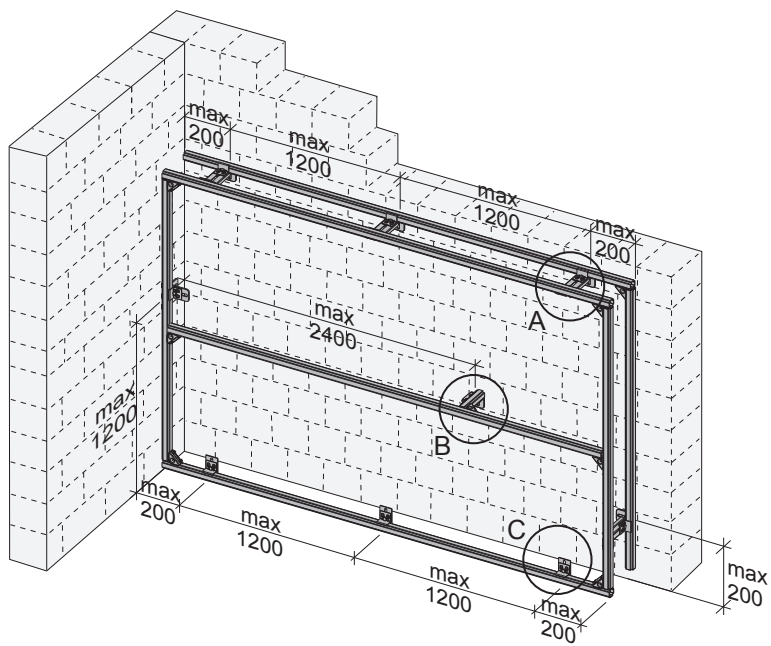

TECEprofil - Systemmontageanleitung/system assembling instructions

1

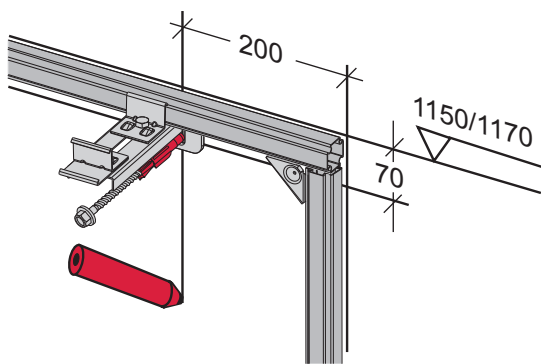
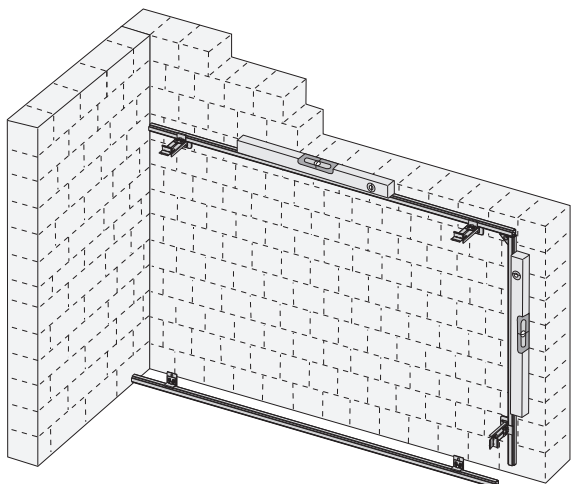

2

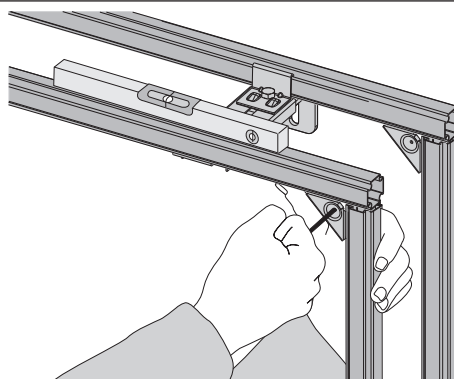
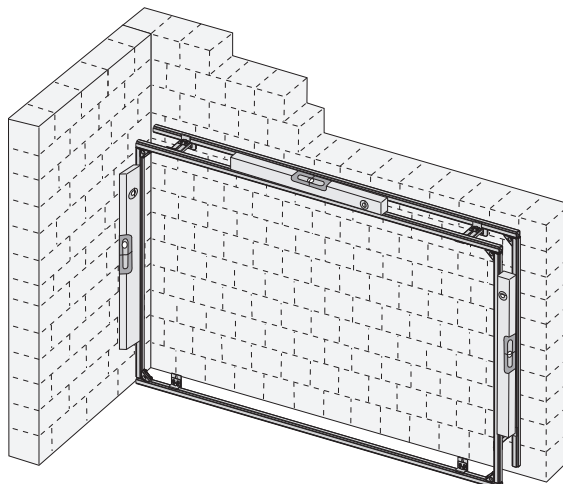

3

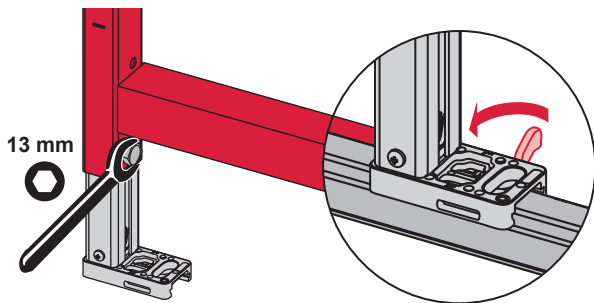
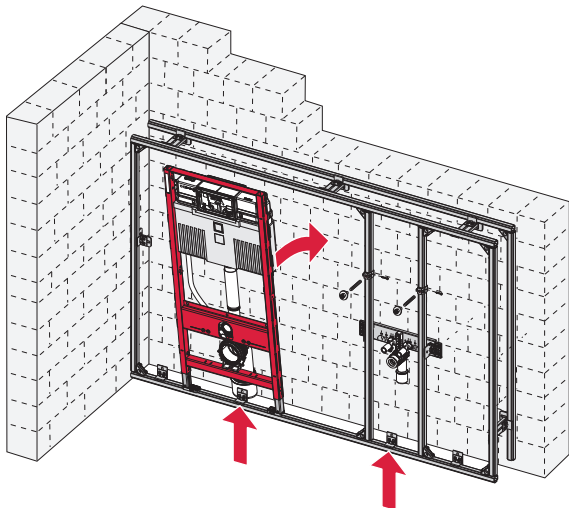

4

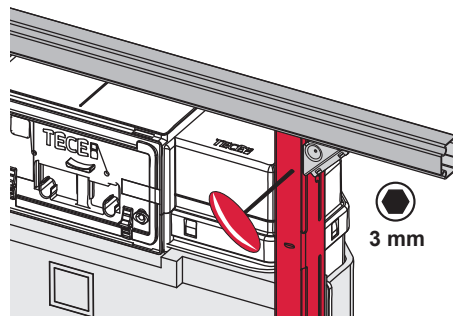
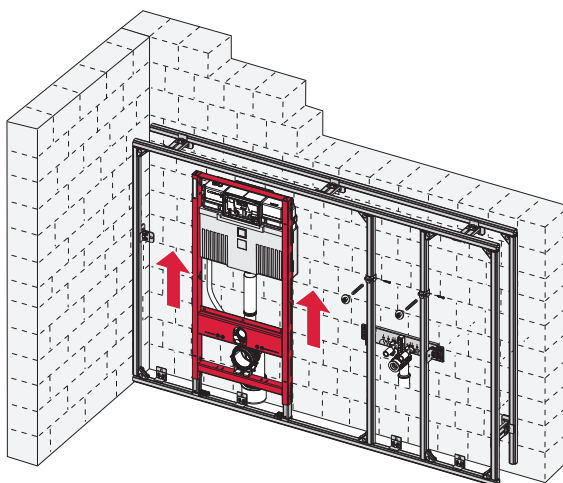

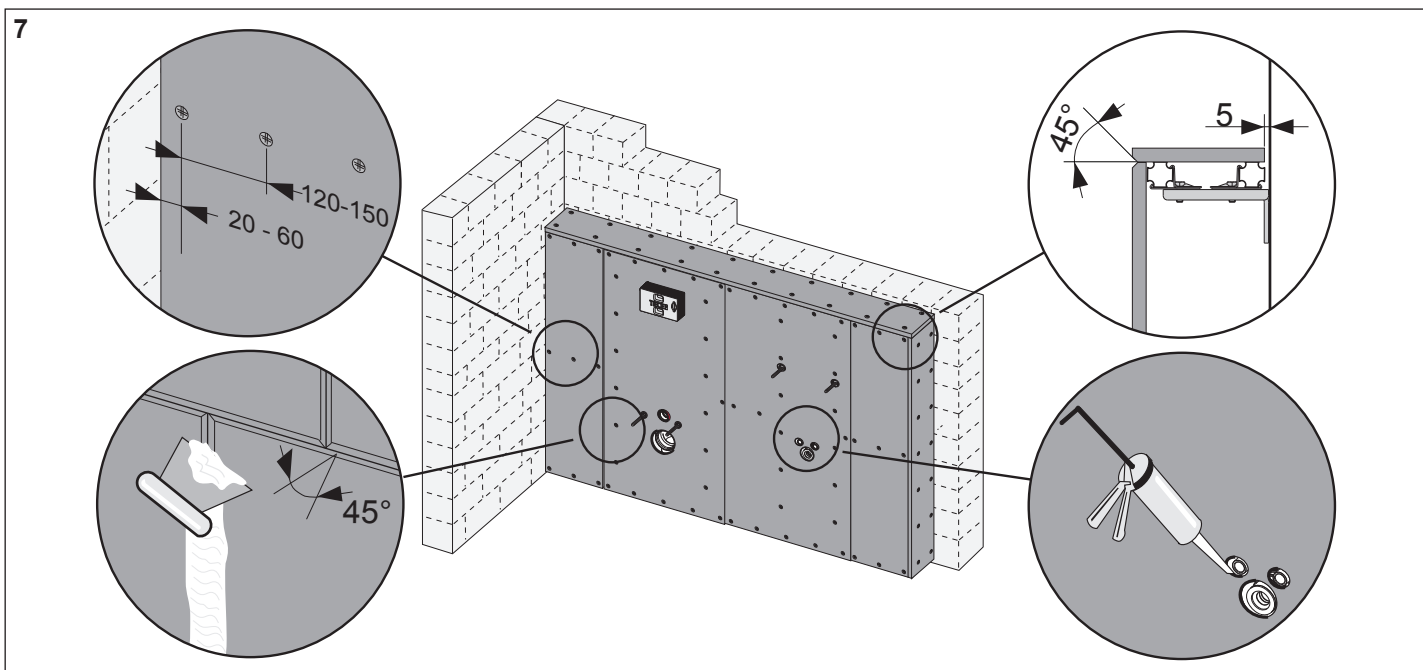
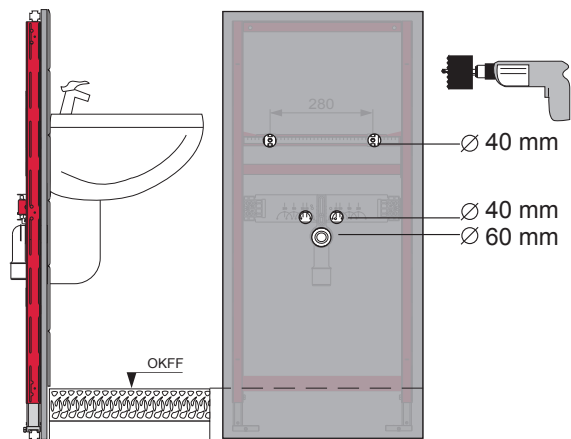
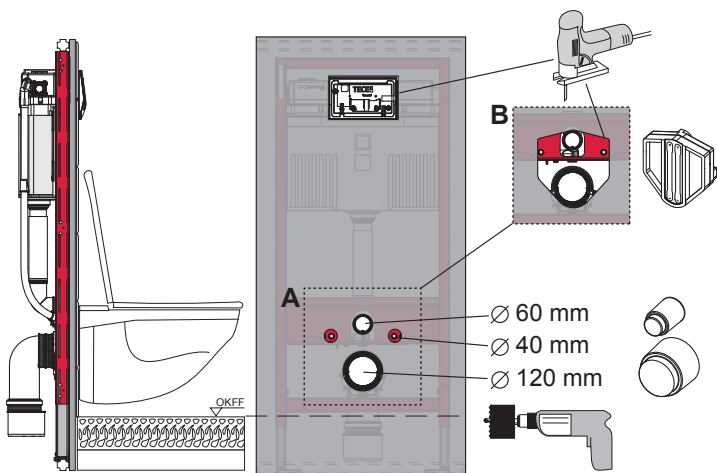
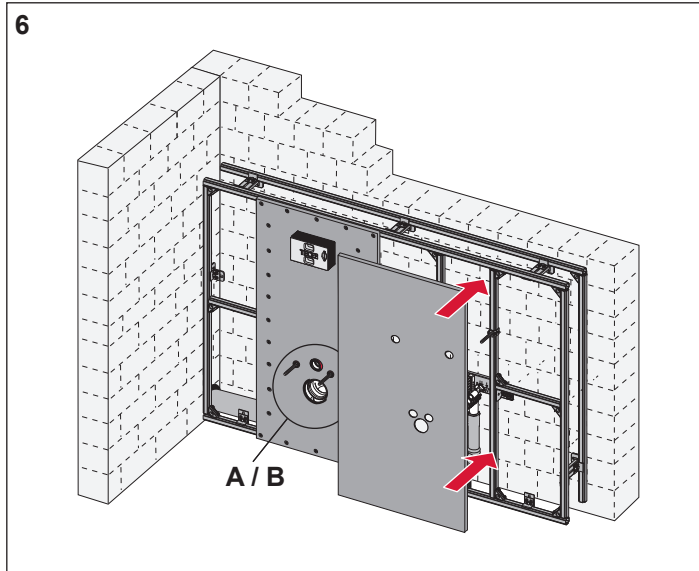
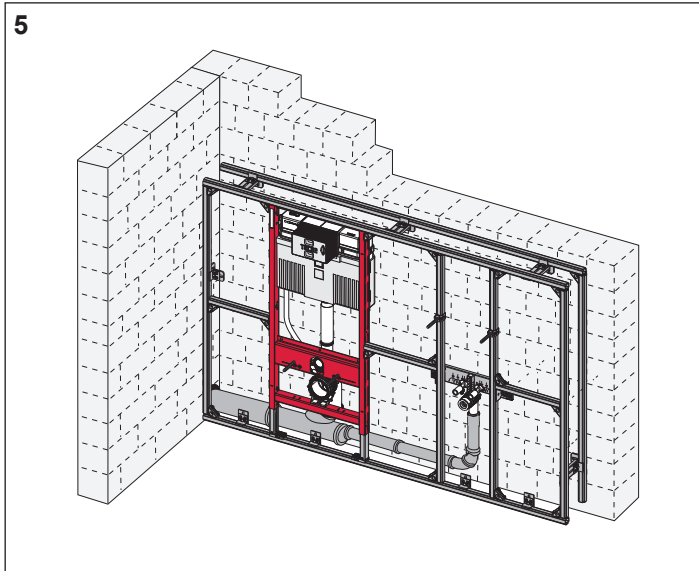

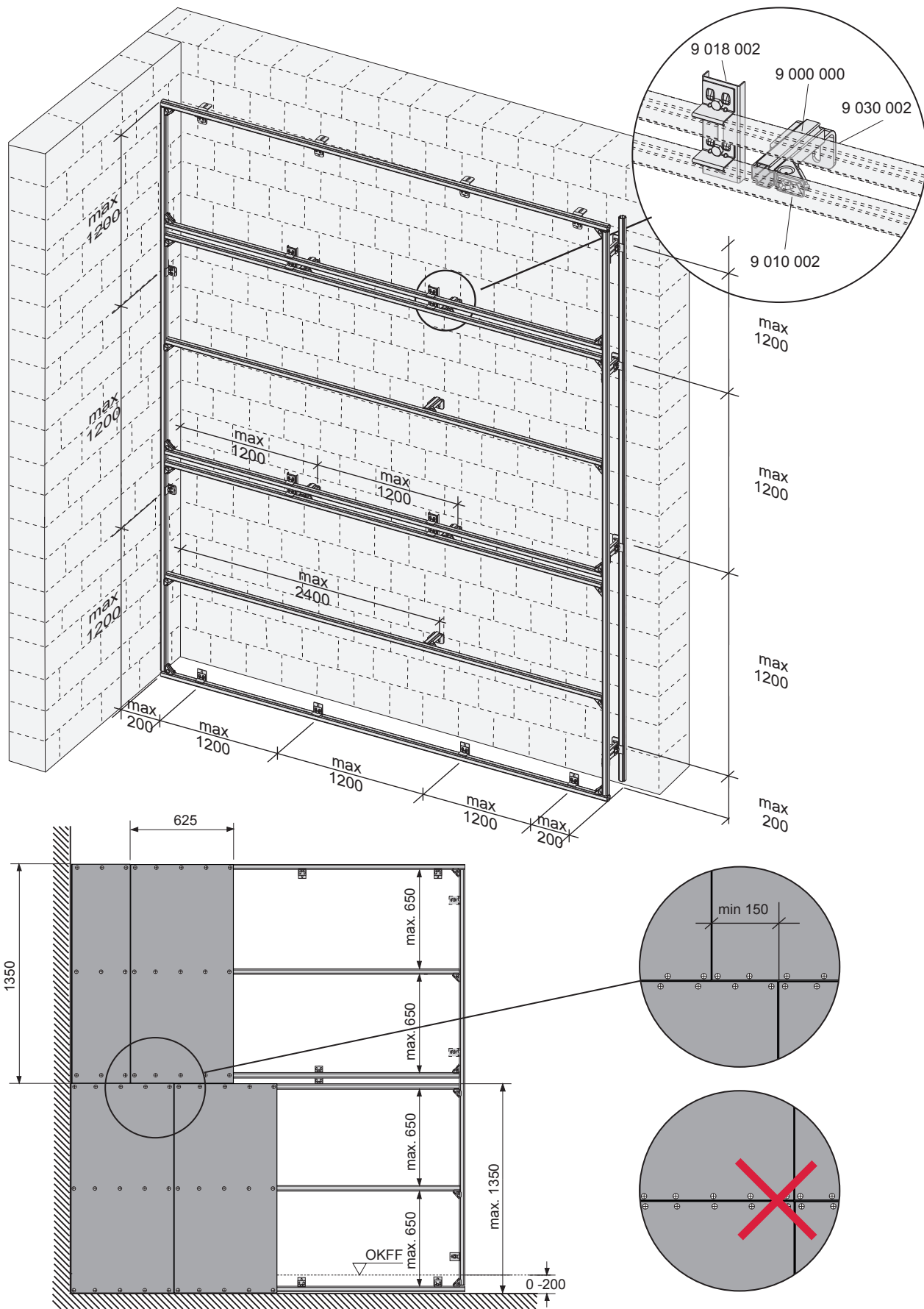

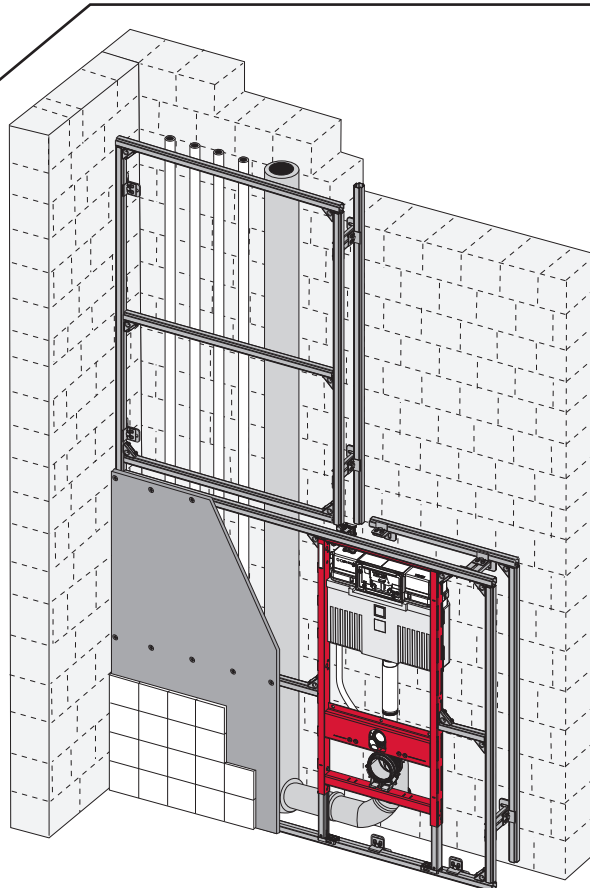
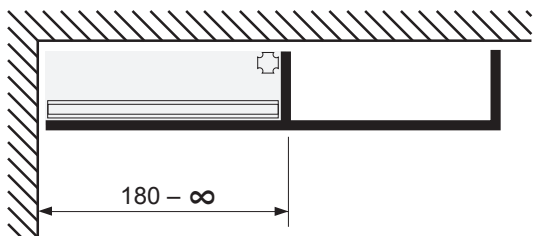
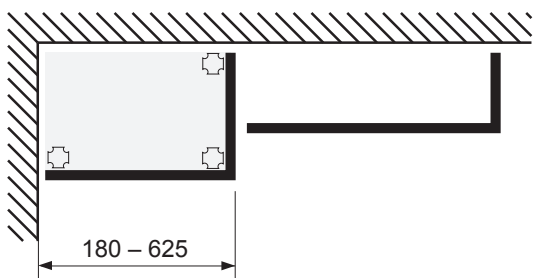
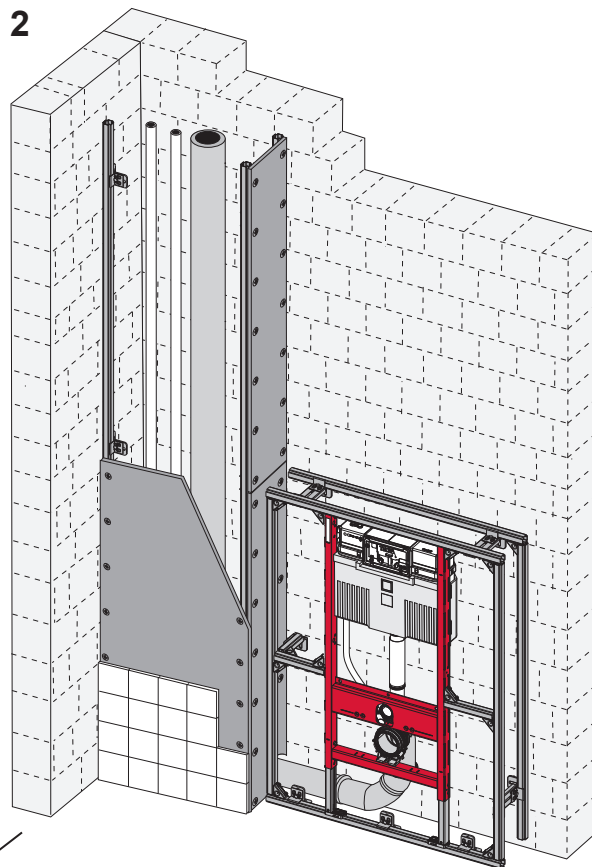
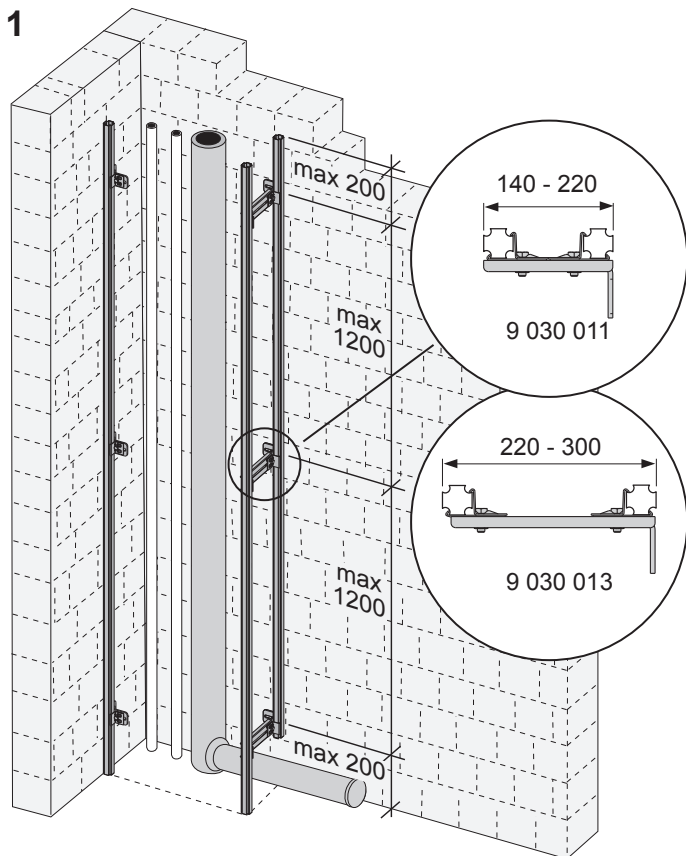

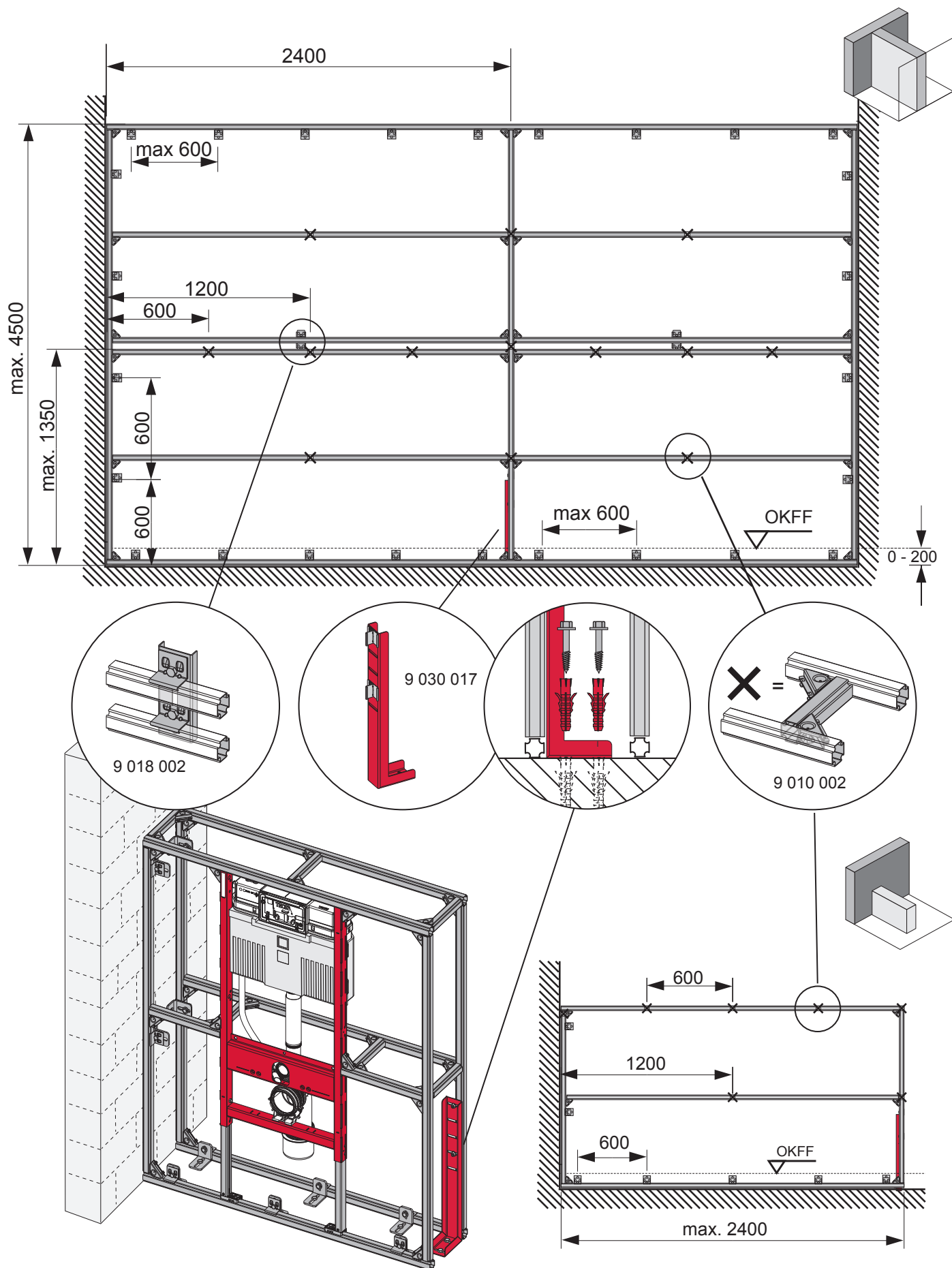

TECEprofil - Systemmontageanleitung/system assembling instructions

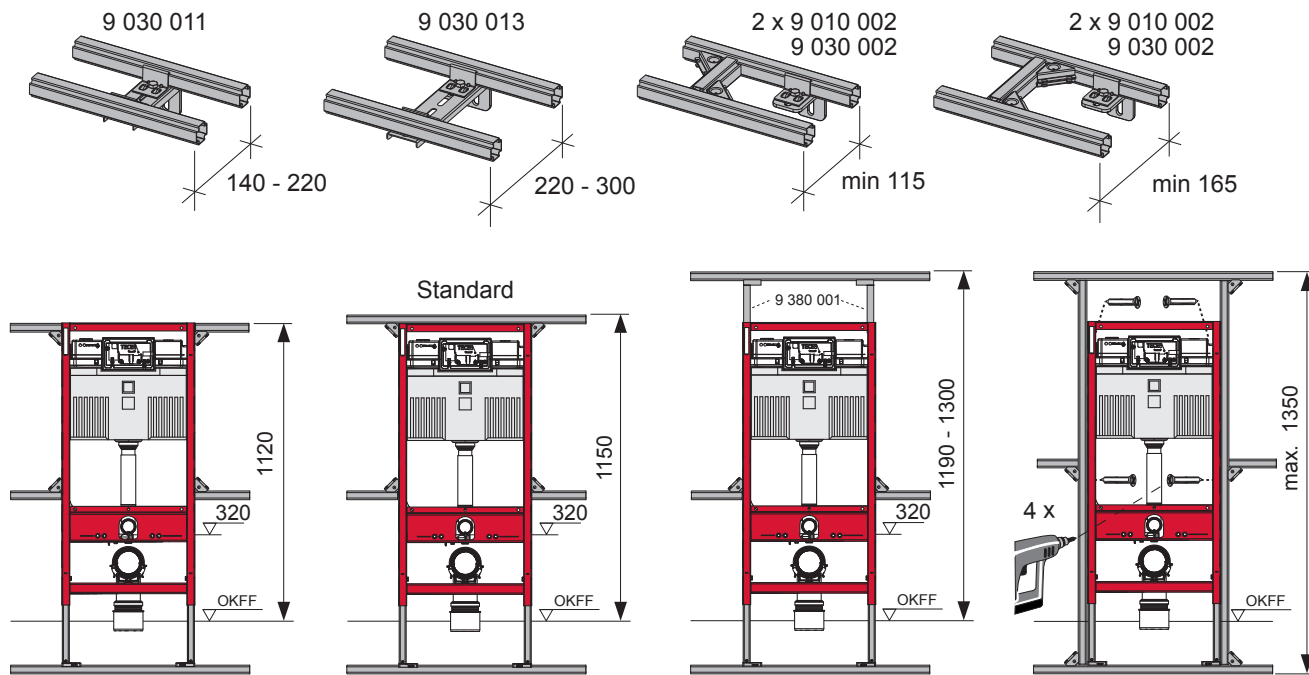

TECEprofil - Systemmontageanleitung/system assembling instructions

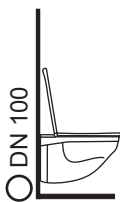
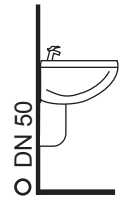

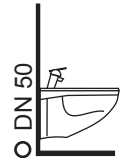
| | Art. Nr. | H Standard | T1 min | T2 min | |
|---|--------------------|-----------------------|--------------|--------------|-----|
|  DN 100 | 9 300 300 | 1150 (1120 - 1350) | 160 | 210 | |
| | 9 300 303 | | | | |
| | 9 300 309 | | | | |
| | 9 300 344 | | | | |
| | 9 300 100 (...) | | | | |
| | 9 300 322 | 980 - 1080 | 160 | 210 | |
| | 9 300 301 | 820 - 920 | 160 | 210 | |
| | 9 041 306 | 970 - 1350 | 160 | 210 | |
|  DN 50 | 9 310 000 | 1150 (1120 - 1350) | 140 (115) | 210 | |
| | 9 310 004 | | | | |
| | | 9 020 033 | 820 - 1350 | 140 (115) | 210 |
| | | 9 020 018 | | | |
| | | 9 020 034 | | | |
|  DN 50 | 9 320 002 | 1150 (1120 - 1350) | 140 (115) | 170 | |
| | 9 320 000 | | | | |
| | 9 320 001 | | | | |
| | 9 020 017 | | | | |
| | | | | | |
|  DN 50 | 9 330 000 | 1150 (1120 - 1350) | 140 (115) | 210 | |

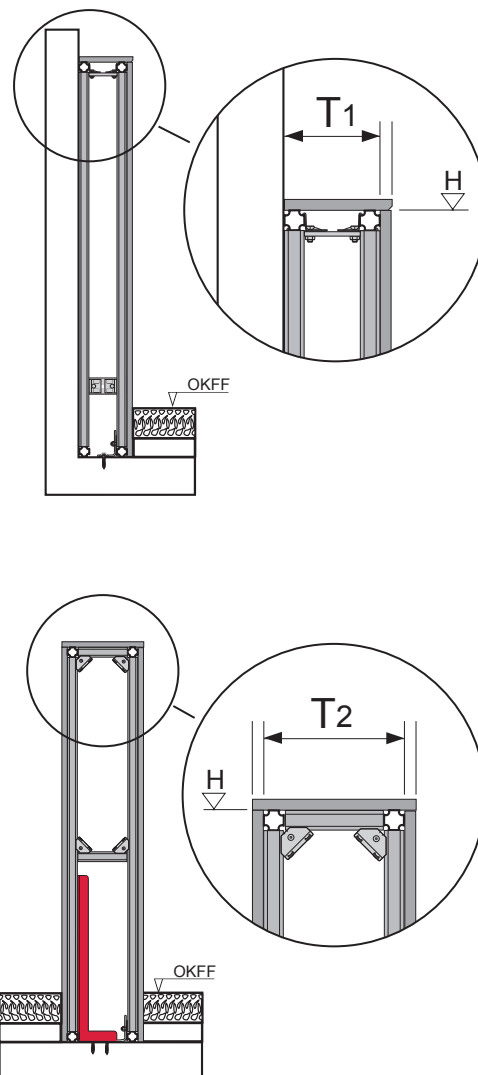

PR 230.414.00 a

Standardkeramik
 Standard ceramics
 Céramique standard
 Cerámica estándar
 Ceramica standard
 стандартная керамика

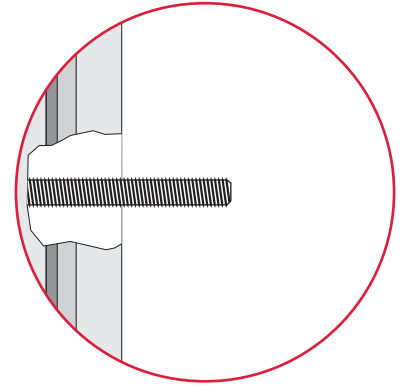
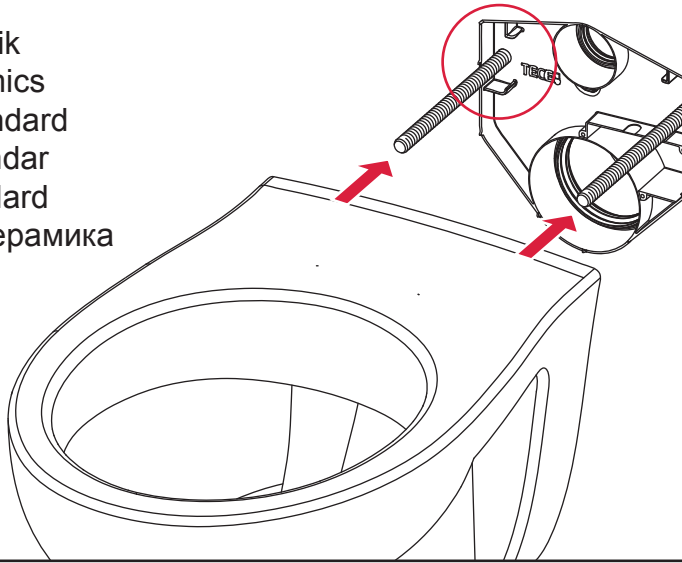

Villeroy & Boch „SupraFix“

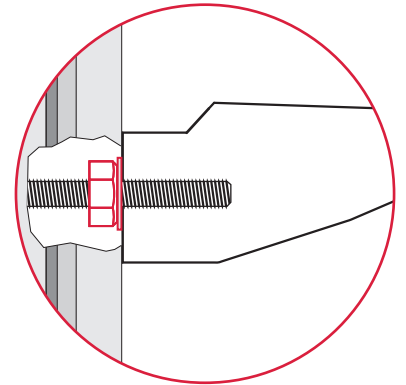
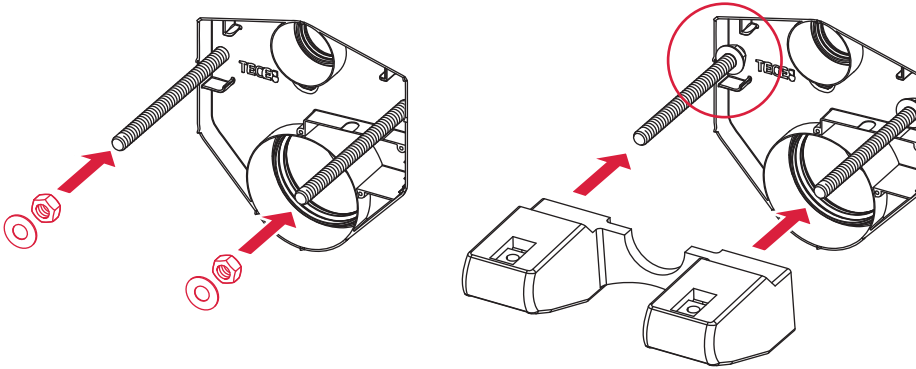

LAUFEN „EasyFit“

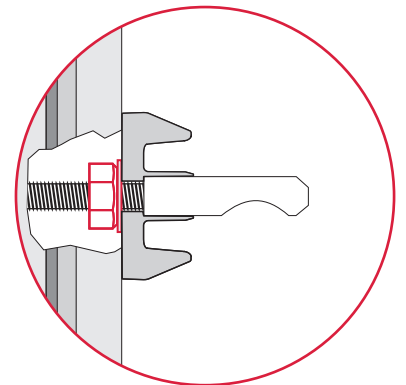
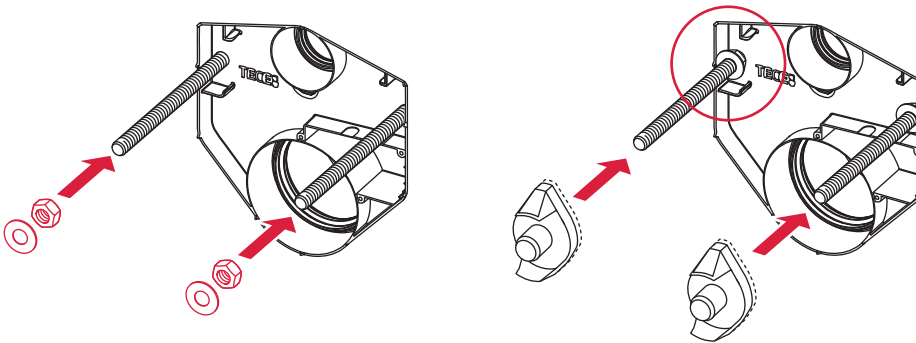

Service A 2 (2019)

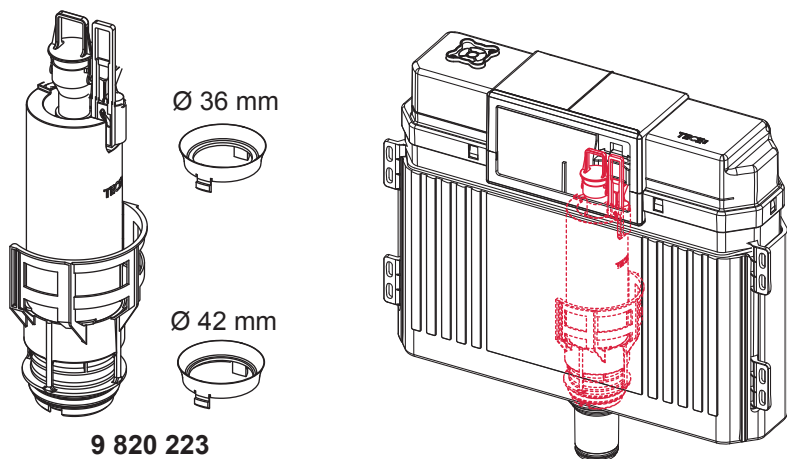

9 820 223

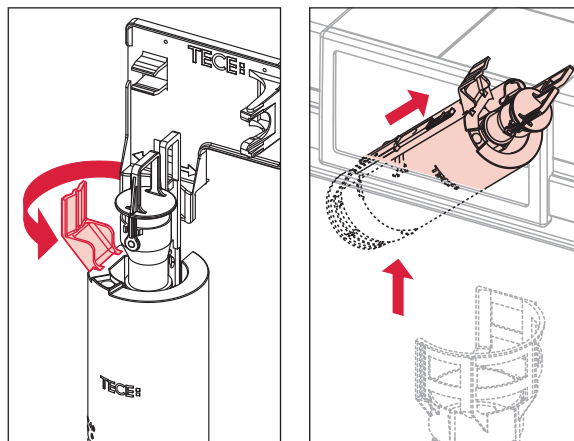

Standardspülmenge: 6 Liter
 Standard flush: 6 litre
 Volume de chasse standard: 6 litres
 Settaggio di fabbrica: 6 litro
 Standaard spoelwater: 6 liter
 Descarga estándar: 6 litros
 Spłukiwanie standardowe: 6 litrów
 Стандартный смыв: 6 литров

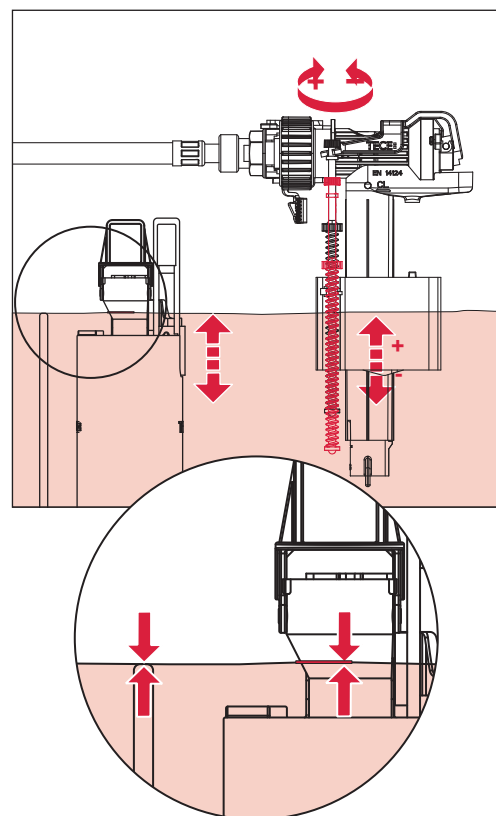
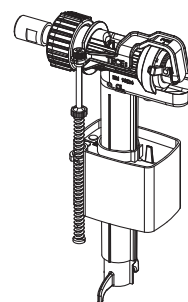
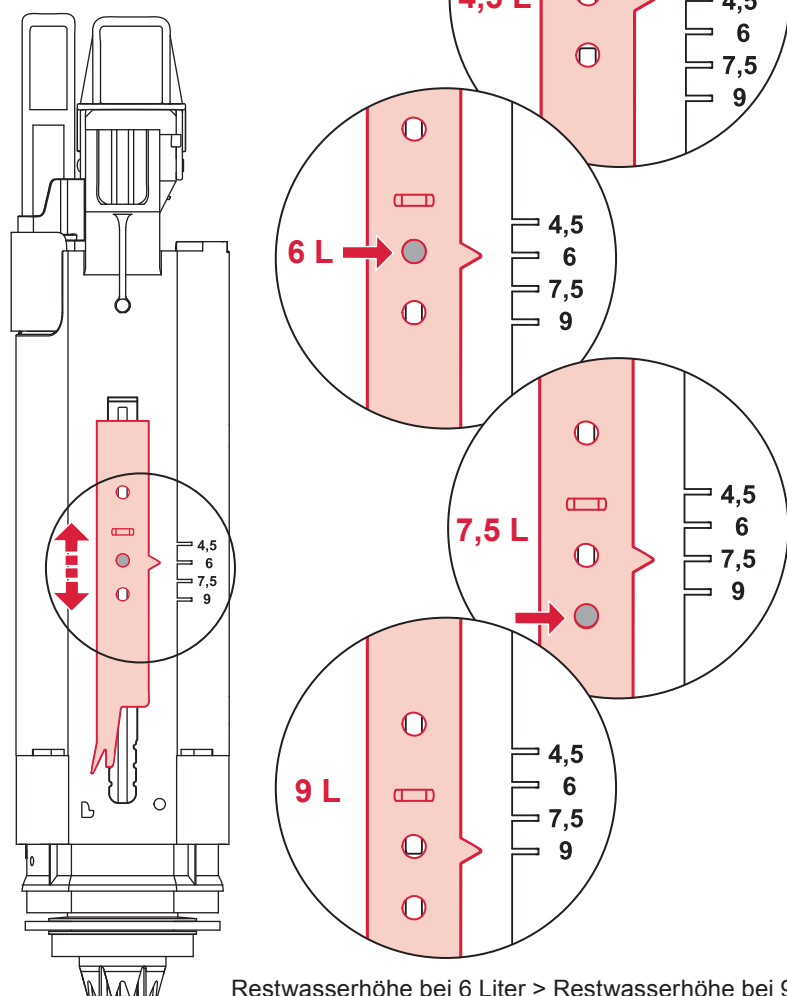

Restwasserhöhe bei 6 Liter > Restwasserhöhe bei 9 Liter
 residual water height at 6 litre > residual water height at 9 litre
 Volume résiduel pour 6 litres > Volume résiduel pour 9 litres



Les réservoirs de chasse homologués NF sont équipés en standard avec un restricteur bleu (diamètre 36 mm), et un réglage du volume de chasse à 6 litres.



Service A 2 (2019)

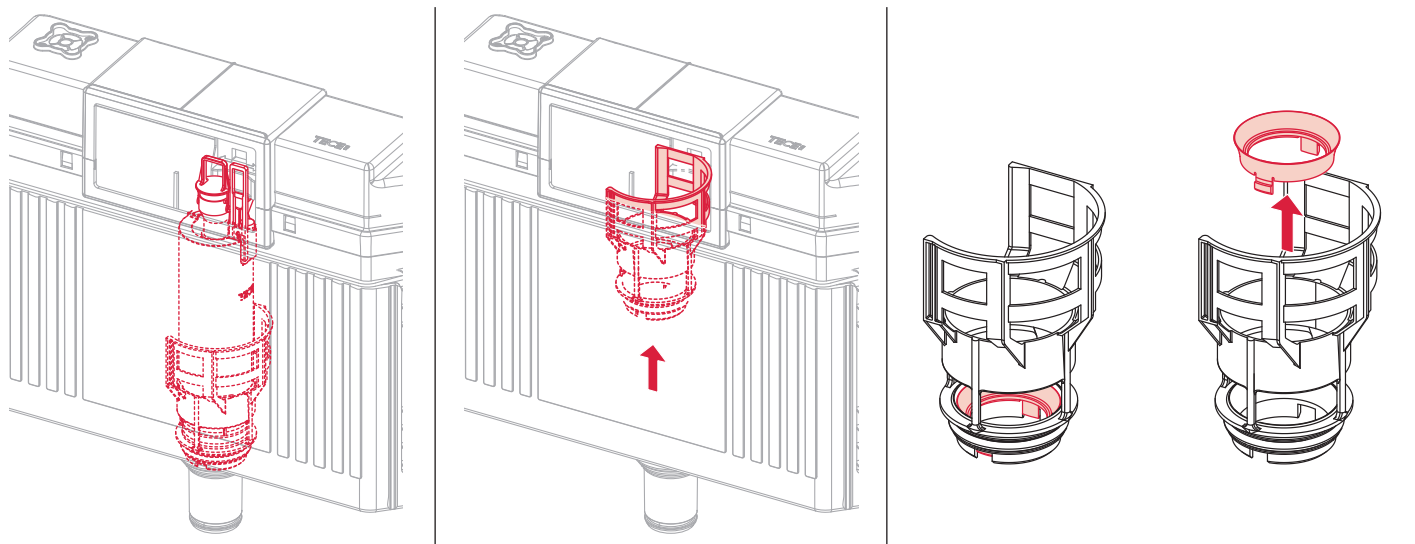

9820337 – Drosselset / Throttle set / Jeu de bague de réglage de débit / Set di riduzione pressione / Set de estrangulamiento / Zestaw dławika / Комплект ограничительных

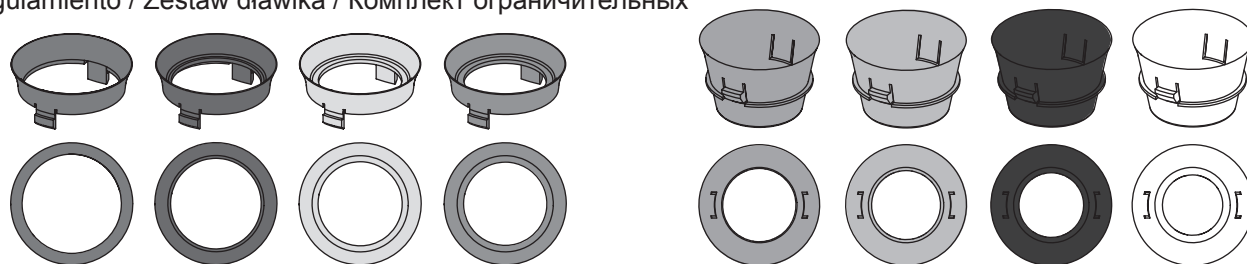

Ø 46 mm Ø 42 mm Ø 39 mm Ø 36 mm

Ø 34 mm Ø 32 mm Ø 30 mm Ø 28 mm

1120/980 mm: ≈ 115 % ≈ 110 % ≈ 105 % ≈ 100 %
820 mm: ≈ 115 % ≈ 100 % ≈ 90 % ≈ 80 %

≈ 95 % ≈ 85 % ≈ 75 % ≈ 65 %
≈ 80 % ≈ 70 % ≈ 55 % ≈ 45 %

Spüldruck / Flushing pressure / Pression de chasse / Pressione di scario / Presión de descarga / ciśnienie spłukiwania / колец давление промывки

Spülung ohne WC-Keramik / Flushing without WC ceramics / Chasse sans cuvette WC / Scarico senza ceramica WC / Spoelen zonder wc-keramiek / Descarga sin cerámica-WC / Spłukiwanie bez ceramiki WC / Смыть без унитаза

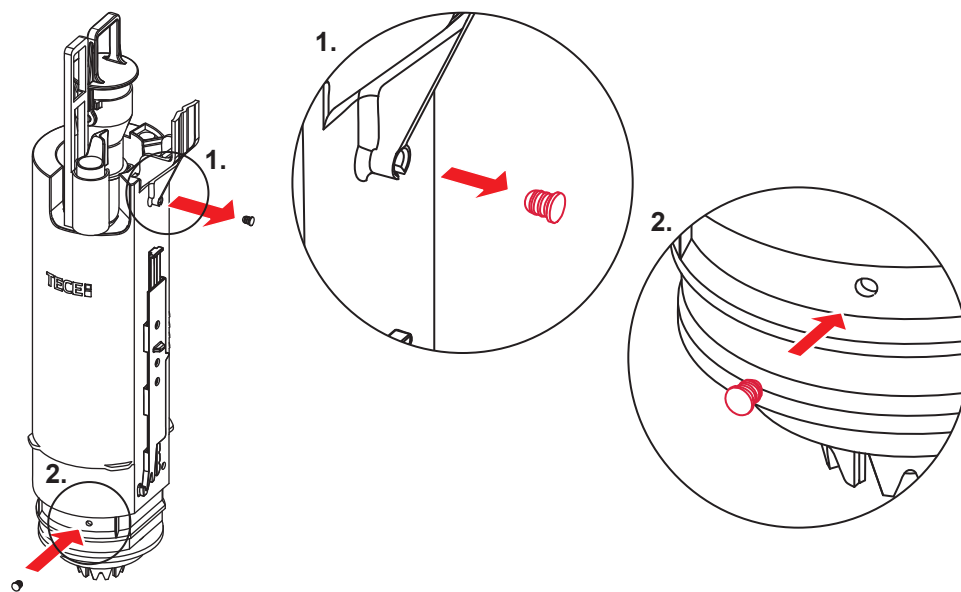
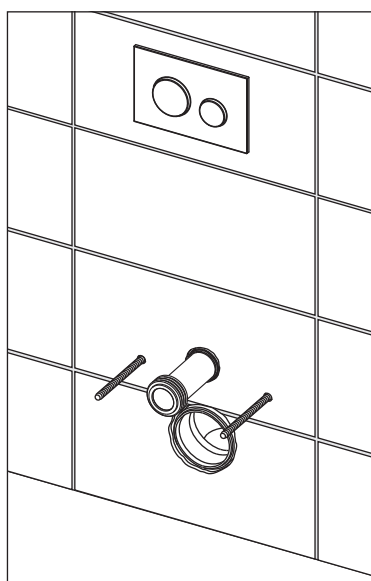

SP430 035 00 n



Les réservoirs de chasse homologués NF sont équipés en standard avec un restricteur bleu (diamètre 36 mm), et un réglage du volume de chasse à 6 litres.

